



DWC-PZV2M72T



Default Login Information

Username: **admin** Password: **admin**

WHAT'S IN THE BOX

Quick Setup and Download Guides		1	PoE Injector and Power Cable		1 set
Waterproof Cap and Gasket		1 set	Star Wrench		1
Moisture Absorber and guide (recommended)		1 set			

ACCESSORIES REQUIRED TO INSTALL THE CAMERA (SOLD SEPARATELY)

Wall mount bracket: DWC-PZWM	Ceiling mount bracket: DWC-PZCM	Parapet mount bracket: DWC-PZPARAM (must be purchased with DWC-PZADP)
------------------------------	---------------------------------	---

NOTE: Download all your support materials and tools in one place

- Go to: <http://www.digital-watchdog.com/resources>
- Search your product by entering the part number in the **'Search by Product'** search bar. Results for applicable part numbers will populate automatically based on the part number you enter.
- Click **'Search'**. All supported materials, including manuals and quick start guide (QSGs) will appear in the results.



Attention: This document is intended to serve as a quick reference for the initial setup. It is recommended that the user read the entire instruction manual for complete and proper installation and usage.

Tel: +1 (866) 446-3595 / (813) 888-9555

digital-watchdog.com

Technical Support Hours:
9:00AM – 8:00PM EST, Monday through Friday

STEP 1 – PREPARING TO MOUNT THE CAMERA

- Mounting surface must withstand three times the weight of the camera.
- Do not let the cables get caught in improper places or the electric line cover to be damaged. This may cause a short or fire.
- CAUTION:** These servicing instructions are for use by qualified service personnel only. To reduce the risk of electric shock do not perform any servicing other than that contained in the operating instructions unless you are qualified to do so.
- This product is intended to be supplied by a UL Listed Power Supply Unit marked “Class 4” or “LPS” or “PS2” and rated 12 Vdc, 1800 mA min.
- The wired LAN hub providing power over the Ethernet (PoE) in accordance with IEEE 802-3at shall be a UL Listed device with the output evaluated as a Limited Power Source as defined in UL60950-1 or PS2 as defined in UL62368-1.
- Unit is intended for installation in a Network Environment 0 as defined in IEC TR 62102. As such, associated Ethernet wiring shall be limited to inside the building.
- Install the moisture packet at the top of the camera's cover.**
 - Remove the moisture absorber from the packaging.
 - Cut the card and folder along the dotted line.
 - Place the moisture absorber at the top of the camera's cover, according to the diagram below.

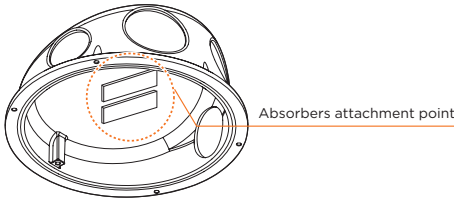

NOTE: The camera will generate enough heat to dry moisture during operation. In most cases it will not need the moisture absorber for more than the first day. In cases where the camera can experience a moisture issue, users must keep the moisture absorber in the camera. The moisture absorber has an approximately 6-month life cycle, varying depending on the environment.

WARNING: It is highly recommended that you install the moisture absorber when mounting the camera. The moisture absorber prevents moisture from being captured inside the camera's housing, which may cause image performance issues and damage the camera.

- Using the mounting template sheet or the camera itself, mark and drill the necessary holes in the wall or ceiling. If you have the new camera hardware, a mounting accessory must be purchased separately.

NOTE: How to tell if you have old or new hardware:

- If your mounting bracket has a safety wire for the camera, you have the new mounting accessory.
- If your mounting bracket has two (2) ridges on the side of the bracket, used to align the camera to lock into position, you have the new mounting accessory.



STEP 2 – POWERING THE CAMERA

Connect the camera to the PoE injector included in the box. Connect the PoE injector to an adequate power source. Refer to the user manual for more options to power up the camera.

Power requirements	Power consumption
DC12V, PoE IEEE 802.3at PoE+ class 4 (High power PoE injector included)	12VDC: 22.5W PoE+: 25.5W

NOTE: When using the PoE+ injector, do not connect the PoE injector to the PoE/PoE+ switch or PoE/PoE+ enabled port of PoE/PoE+ switch.

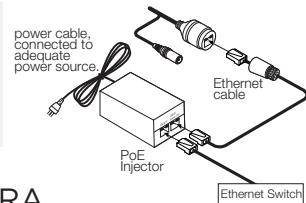

STEP 3 – MOUNTING THE CAMERA

- To use the camera's waterproof wiring:
 - Install the LAN cable into **a**.
 - b** will be assembled to **a** with a 1/4 turn.
 - Thread **c** tightly to **b**.

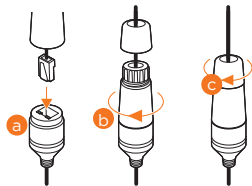

NOTE: To ensure moisture seal, make sure the o-ring is in place between **a** and **b**. Use an outdoor-rated sealer for extreme environments.

NOTE: When using the waterproof cap, crimp the RJ45 connector after passing the cable through the waterproof cap.

- Once all cables are connected, secure the camera to the mounting surface using the included screws.
 - When using the new mounting brackets, make sure to align the wedge on the side of the camera with the one on the mounting bracket. Rotate the camera clockwise to lock into position.
 - When using the old mounting brackets, use the mounting screws included with the camera to secure the camera to the mounting bracket or mounting surface.

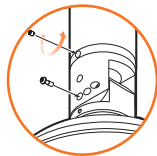
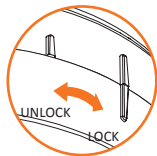

- The camera's four individual sensors can be rotated and tilted to adjust the camera's views. The lens module's max tilt is 18° and rotation is 53°.
- Assemble the dome cover over the camera body and detach the protecting film to complete the installation. You can adjust the camera's angle by loosening the screws on the mounting accessory's bracket/

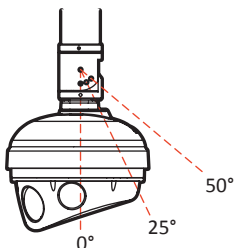

Using a new mounting bracket

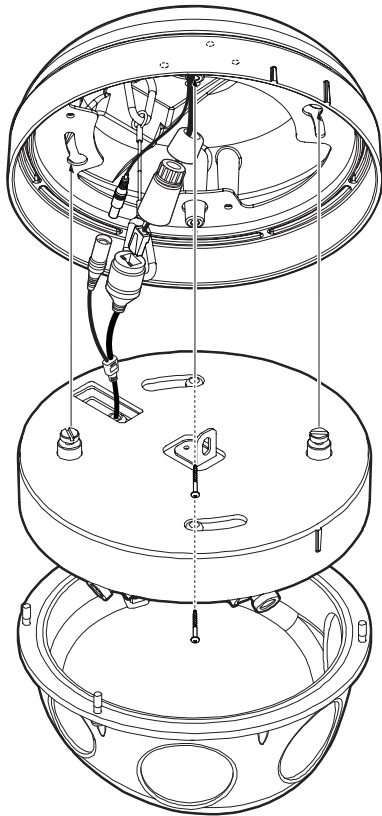

Using an old mounting bracket

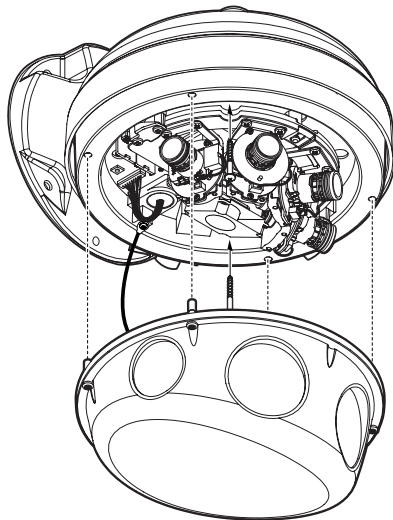
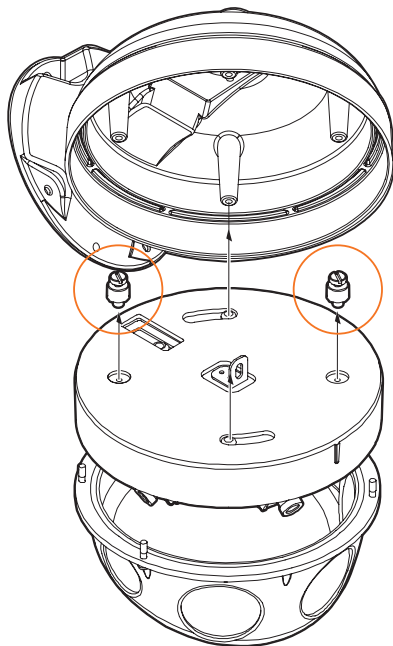

Resetting the camera: Use the tip of a paper clip or a pencil and press the reset button at the base of the camera for five (5) seconds. This will initiate a camera-wide reset of all the settings, including network settings.

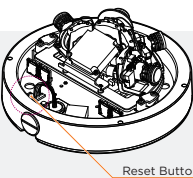

STEP 5 – DW IP FINDER™

Use the DW® IP Finder™ software to scan the network and detect all MEGApix® cameras, set the camera's network settings or access the camera's web client.

The screenshot shows the DW IP Finder Ver 4.4.0 software interface. On the left, there is a sidebar with several controls: a 'Network' dropdown set to 'IP CAM [192.168.150.100]', a 'Devices' dropdown set to 'All', a 'Scan Devices' button, a 'Thumbnail' checkbox which is checked, a 'Refresh Thumbnail' button, a 'Bulk IP Assignment' button, and a 'FW Upgrade' button. The main area displays a table of detected devices. The table has columns: Name, IP Address, Model, MAC Address, Netmask, Gateway, Port, DHCP, Version, Ping Test, IP Conf., and Uptime. There are 15 devices listed. Annotations with orange lines point to various parts of the interface: 'Thumbnail view' points to the 'Thumbnail' checkbox; 'Select network to scan' points to the 'Network' dropdown; 'Filter device type to scan' points to the 'Devices' dropdown; 'Scan devices' points to the 'Scan Devices' button; 'Show/hide thumbnail view' points to the 'Thumbnail' checkbox; 'Refresh thumbnail view' points to the 'Refresh Thumbnail' button; 'Bulk IP assignment' points to the 'Bulk IP Assignment' button; 'Firmware upgrade' points to the 'FW Upgrade' button; 'Firmware version' points to the 'Version' column header; 'Camera's uptime' points to the 'Uptime' column header; 'Open Device configuration settings' points to the 'Click' button in the 'IP Conf.' column; and 'Device's information' points to the 'Name' column header.

STEP 6 – WEB VIEWER

Once the camera's network settings have been setup properly, you can access the camera's web viewer using the DW IP Finder™.

To open the camera's web viewer:

1. Find the camera using the DW® IP Finder™.
2. Double-click on the camera's view in the results table.
3. Press the 'View Camera Website'. The camera's web viewer will open up in your default web browser.
4. Enter the camera's username and password (default is admin/admin).
5. If you are accessing the camera for the first time, install the ActiveX files in order to view video from the camera.
6. To adjust the camera's sensors alignment, use the arrow buttons under each sensor preview to achieve the proper alignment.

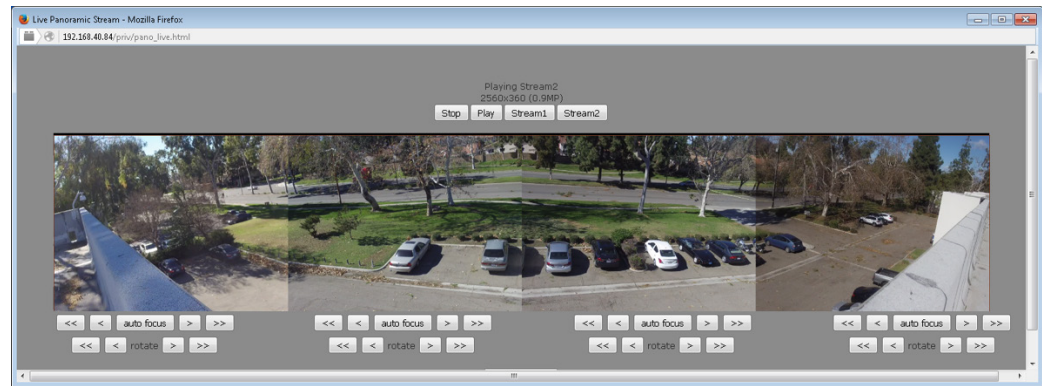

Network setup

1. To install the DW® IP Finder™, go to <http://www.digital-watchdog.com>
2. Enter "DW IP Finder" on the search box at the top of the page and press Enter.
3. Click on the DW® IP Finder™ from the search result and go to the Software tab. Click on the download icon to download the DW® IP Finder™ installation file.
4. Run the installation file and follow the wizard to install the DW® IP Finder™. Open the DW® IP Finder™ and click 'Scan Devices'. It will scan the selected network for all supported devices and list the results in the table. During the scan, the DW® logo will turn gray.

- i** Select DHCP if the internet service is dynamic IP. This will allow the camera to receive its IP address from the DHCP server.
- i** Select "Static" to manually enter the camera's IP address, (Sub) Netmask, Gateway and DNS information.
- i** The camera's IP must be set to Static if connecting to DW Spectrum® IPVMS. Contact your network administrator for more information.

i Default TCP/IP information: DHCP

5. Select a camera from the list by double-clicking on the camera's image or clicking on the 'Click' button under the IP Conf. column. The pop-up window will show the camera's current network settings, allowing admin users to adjust the settings as needed.
6. To access the camera's web page, click on 'View Camera Website'.

7. To save the changes made to the camera's setting, input the username and password of the camera and click Apply. Click "Scan Devices" from the main screen again to display the updated information.

i 'Port forwarding' has to be set in your network's router for external access to the camera.

Default ID / PW: admin / admin

***NOTE:** For security purposes, it is highly recommended to change your password after initial setup.

The screenshot shows the 'DW Camera Settings' window. It contains fields for 'Camera Name' (DWC-MD421TJR), 'MAC Address' (00:0D:F1:20:A4:9E), and 'IP Configuration Mode' (DHCP selected). Below these are fields for 'IP Address' (192.168.1.101), 'Netmask' (255.255.255.0), 'Gateway' (192.168.1.1), and 'DNS' (192.168.40.1). There is a 'Ports' section with fields for 'Web Port' (80), 'Control Port' (0), 'Video Port' (0), 'Audio Transmit' (0), and 'Audio Receive' (0). At the bottom, there are fields for 'Username' (admin) and 'Password' (masked with dots). Buttons at the bottom include 'Restore default camera configuration', 'View Camera Website', 'Apply', 'Reboot', and 'Cancel'.

NOTE: Please see the full user manual for web viewer set up, functions and camera settings options.